

Goose Box Safety Chain Kit 16K

WARNING: Under no circumstances should the towing vehicle manufacturer's recommended vehicle towing capacity be exceeded. Failure to follow instructions for installation and use may cause property damage, injury or death.

READ ALL INSTRUCTIONS BEFORE STARTING THE INSTALLATION OR USE

DEALER/INSTALLER:

1. Provide this Instructions to end user

END USER:

1. Read and follow these Instructions for the Reese Goose Box Safety Chain Kit Installation.
2. Save these instructions for future reference.
3. Pass on copies of the instructions to any other users or owner.

Do Not Exceed Lower of Towing Vehicle Manufacturer's Rating, Trailer Manufacturer's Rating or

Max Gross Trailer WT (LB)	Max Pin WT (LB)
16,000 LB	3,200 LB

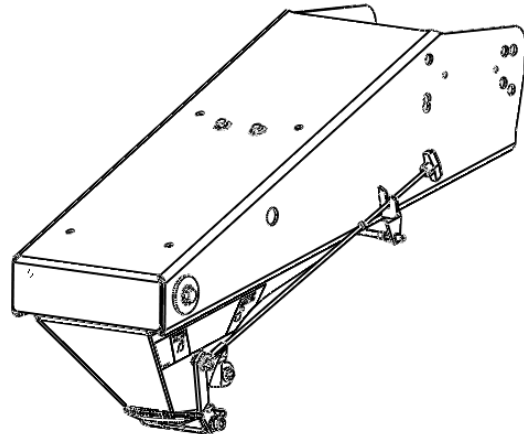

Equipment Required:

Fastener Kit: 49150F

Wrenches: 3/4"

Drill Bits: Not Required

Misc.: 3/4" Socket & Torque Wrench

INDEX

1. Explosion, Parts Identified, Instructions P. 1
2. 5 Year Limited Warranty P. 2

Item Number	Quantity	Description
1	1	Goose Box (94716 or 94622)
2	2	44" Chain w/Hook (123545)
3	2	1/2" Washer Flat (01160008)
4	2	1/2" Nuts (122399)
5	2	1/2"-13x2.25 Bolts (01150009)
6	2	1/2" Lockwasher (01129008)

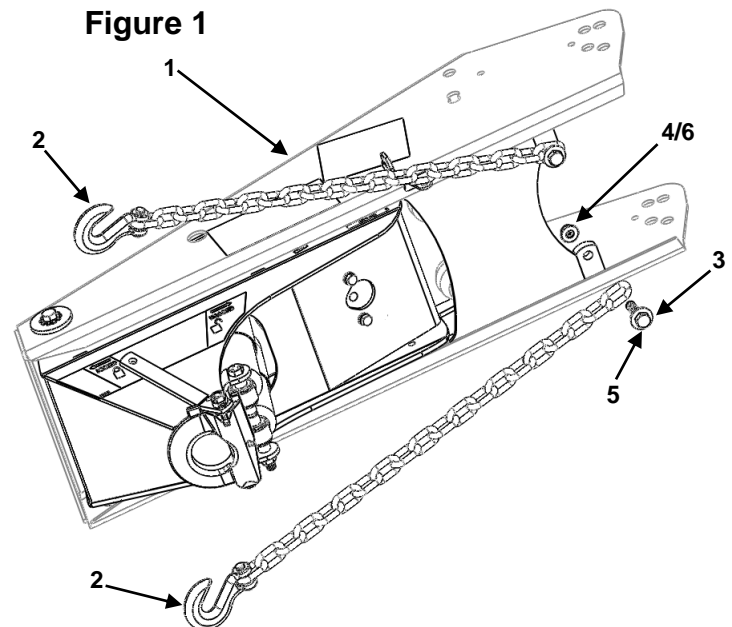

NOTE: For any questions, please

- Scan QR code
- Visit <https://qr.towingproducts.net>
- Or call Technical Service at: 1-800-632-3290



Installation Procedure:

1. Locate safety chain mounting lugs on the underside of Goose Box, as shown in Figure 1.
2. Put flat washer onto bolt, insert through last link in chain.
3. Insert bolt, washer, and chain assembly through hole in mounting lug. Secure with hex nut and lock washer.
4. Tighten bolt, torque to 110 Ft. Lbs. Repeat on other chain.

Installation Instructions

Goose Box Safety Chain Kit 16K

Part Number:
49150

NOTES:

LIMITED FIVE YEAR WARRANTY

- Limited Warranty.** Horizon Global Corp ("We" or "Us") warrants to the original consumer purchaser only ("You") that the product will be free from material defects in both material and workmanship for a period of five years, ordinary wear and tear excepted; provided that installation and use of the product is in accordance with product instructions. There are no other warranties, express or implied, including the warranty of merchantability or fitness for a particular purpose. If the product does not comply with this limited 5 year warranty, Your sole and exclusive remedy is that We will replace the product without charge to You and within a reasonable time or, at our option, refund the purchase price. This warranty is not transferable.
- Limitations on the Warranty.** This limited warranty does not cover: (a) normal wear and tear; (b) damage through abuse, neglect, misuse, or as a result of any accident or in any other manner; (c) damage from misapplication, overloading, or improper installation, including welds; (d) improper maintenance and repair; and (e) product alteration in any manner by anyone other than Us, with the sole exception of alterations made pursuant to product instructions and in a workmanlike manner.
- Obligations of Purchaser.** To make a warranty claim; contact Us at 47912 Halyard Drive Suite 100, Plymouth, MI, 48170, or 1-888-521-0510. Identify the product by model number and follow the claim instructions that will be provided. Any returned product that is replaced or refunded by Us becomes our property. You will be responsible for return shipping costs. Please retain your purchase receipt to verify date of purchase and that You are the original consumer purchaser. The product and the purchase receipt must be provided to Us in order to process Your warranty claim.
- Remedy Limits.** Repair or replacement is Your sole remedy under this limited warranty or any other warranty related to the product. We shall not be liable for service or labor charges incurred in removing or replacing a product or any incidental or consequential damages of any kind.
- Assumption of Risk.** You acknowledge and agree that any use of the product for any purpose other than the specified use(s) stated in the product instructions is at Your own risk.
- Governing Law.** This limited warranty gives You specific legal rights, and You also may have other rights which vary from state to state. This limited warranty is governed by the laws of the State of Michigan, without regard to rules pertaining to conflicts of law. The state courts located in Oakland County, Michigan shall have exclusive jurisdiction for any disputes relating to this warranty.

Horizon Global Corp
47912 Halyard Drive Suite 100
Plymouth, MI 48170